

Mead Road, Edgware, Greater London. HA8 6LH



- One Bedroom
- Ground Floor
- End of Terrace
- Converted Maisonette
- Own Garden
- Long Lease (999 years from June 1974)
- Peppercorn Ground Rent
- Full Of Charm
- Great Investment Opportunity
- No Upper Chain

£299,950
Subject To Contract



MELVIN JACOBS ESTATE AGENTS
Sales, Lettings & Block Management

45/47 Manor Park Crescent, Edgware, Middlesex, HA8 7LY
Tel 020 8381 2908 www.melvinjacobs.com

**MELVIN
JACOBS**
020 8381 2908



**MELVIN
JACOBS**



Bedroom 1 (11' 2" x 11' 1") or (3.41m x 3.39m)

Lounge/Dining Area (12' 10" x 11' 9") or (3.90m x 3.59m)

Kitchen (11' 6" x 8' 6") or (3.50m x 2.60m)

Bathroom

GARDEN (26' 3" x 9' 10") or (8.00m x 3.00m)

Tenure

We are informed that the tenure is Leasehold

Council Tax

Council tax band: B

Viewing

Strictly By Appointment Only. Melvin Jacobs, 020 8381 2908

Melvin Jacobs Estate Agents
45 - 47 Manor Park Crescent,
Edgware,
Middlesex,
HA8 7LY

e: info@melvinjacobs.com

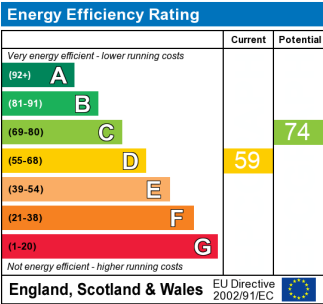

The energy efficiency rating is a measure of the overall efficiency of a home. The higher the rating the more energy efficient the home is and the lower the fuel bills will be.

Mead Road, Edgware, HA8 6LH

Approximate Area = 490 sq ft / 45.5 sq m

For identification only - Not to scale

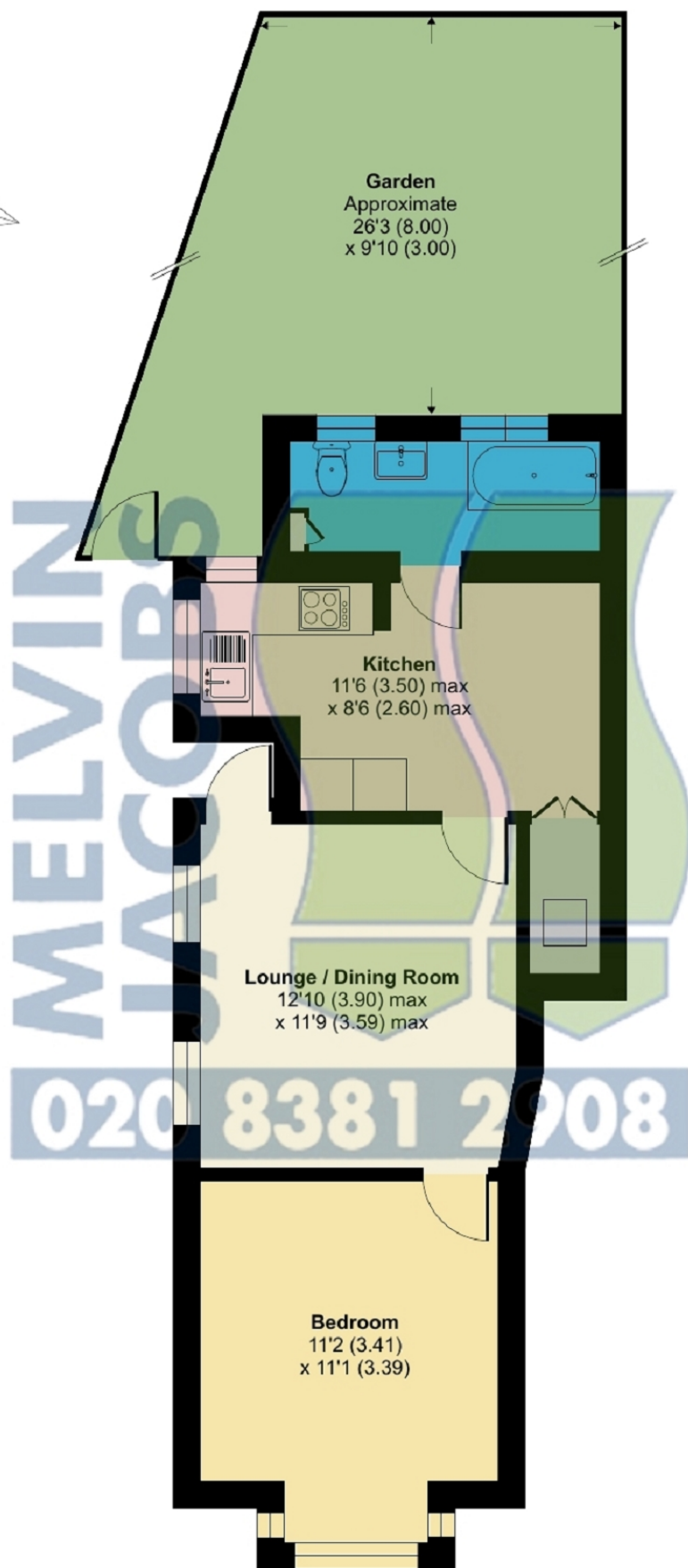

GROUND FLOOR

